



## Seal Type 74 - Reverse Balance Multi Spring

### PRODUCT DESCRIPTION

Seal Type 74 Mechanical Seal are Externally Mounted Reverse Balanced Design Seal having 'O' Ring as a Secondary Sealing member. Secondary Sealing member can be changed as per Chemical Compatibility. All metal components including springs are Isolated from the Sealed, Aggressive Medium. Simple checkout method function and cleaning possibility as this Mechanical Seal located easily access outside the pump. Especially design Clamp Ring eliminate Slipping on Shaft.

### DESIGN FEATURES

Single Acting Mechanical Seal. Dual Directional Mechanical Seal. Outside Mounted Mechanical Seal. Reverse Balanced Design. Multi-Spring Design Mechanical Seal.

### MATERIALS

Seal Ring Faces	: Carbon and SiC
Seat Faces	: Ceramic and SiC
Elastomer	: Viton, EPDM, TTV, FEP and FFKM
MOC	: SS 316, Hast -C and Alloy 20

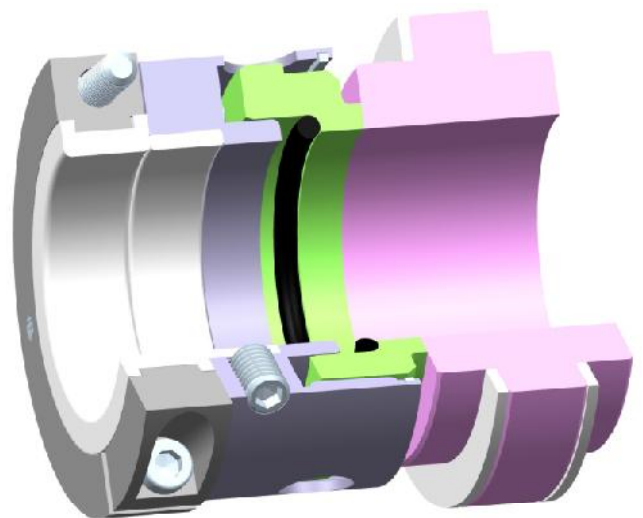

### OPERATING CAPABILITIES

Shaft Dia.	: 16mm to 70mm
Pressure	: Up to 8 bar
Temperature	: Up to 120°C
Speed	: 3000 r.p.m.



**Type - 74**

**Reverse Balance Multi Spring**

- | Part No. | Description     |
|----------|-----------------|
| 1        | Seal Ring       |
| 2        | O-Ring          |
| 2.1      | Packing         |
| 2.2      | Packing         |
| 4        | Spring          |
| 5        | Spring Holder   |
| 6        | Snap Ring       |
| 7        | Set Screw       |
| 8        | Seat            |
| 10       | Gasket          |
| 14       | Allen Cap Screw |
| 27       | Clamp Ring      |

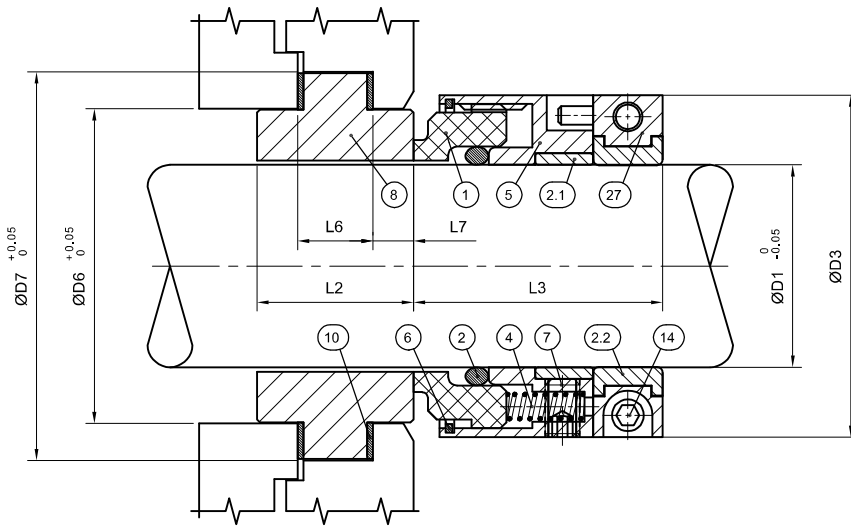

SEAL SIZE		D3	D6	D7	L3	L2	L6	L7
inch	mm							
0.750	19.05	38.00	36.00	46.50	32.50	18.00	11.00	3.50
0.875	22.22	40.70	39.50	50.20	32.50	18.00	11.00	3.50
1.000	25.40	50.00	42.50	53.50	41.00	18.00	11.00	3.50
1.125	28.58	51.50	46.00	59.50	42.50	27.00	14.00	6.50
1.250	31.75	55.00	50.80	64.00	42.50	27.00	14.00	6.50
1.375	34.92	59.00	54.00	67.00	42.50	27.00	14.00	6.50
1.500	38.10	63.00	57.00	69.50	42.50	27.00	14.00	6.50
1.625	41.28	64.00	61.50	75.50	42.50	27.00	14.00	6.50
1.750	44.45	70.50	64.00	76.50	50.00	27.00	14.00	6.50
1.875	47.62	73.50	70.00	83.50	50.00	27.00	14.00	6.50
2.000	50.80	77.00	76.00	90.50	50.00	27.00	14.00	6.50
2.125	53.98	81.50	78.00	93.50	54.50	35.00	18.00	8.50
2.250	57.15	84.20	76.00	93.50	54.50	35.00	18.00	8.50
2.375	60.32	87.50	80.00	98.50	54.50	35.00	18.00	8.50
2.500	63.50	91.00	85.50	100.50	54.50	35.00	18.00	8.50

Due to continuous improvement specifications and dimensions may change without prior notice.