



Seal Type ZR800/S - Single Cartridge

PRODUCT DESCRIPTION

The Universal Cartridge ZR800/S Series is a modular cartridge seal family that includes elastomer o-ring pusher seal designs. Type ZR800/S single seal arrangements incorporate an elastomer o-ring as the secondary sealing member. A common seal head/mating ring set, utilized throughout all versions, is reversible to allow rotating. Seat/mating ring or rotating seal head operation, and is interchangeable with metal bellows seal heads. Seal has an optional quench gland with carbon ring throttle bushing.

DESIGN FEATURES

Balance Pusher Seals available in Single and Dual Configuration used for Sealing Environmentally. Dual Directional. Stationary spring design. Reversible Seal Head. Non clogging Wave Spring outside the Product. Components in Cartridge Design are Builds for the Highest Reliability and Simple Installation. Hydraulic Balance Seal Permits using high Pressure as well as it Create Low Heat Generated on Faces and provides long Life. Unitized, Easy-to-Fit Design.

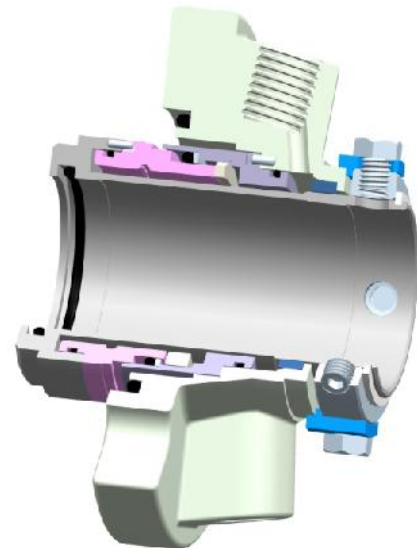

MATERIALS

Seal Ring Faces : Carbon, SiC and TC
Seat Faces : SiC and TC
Elastomer : Viton, PTFE, FEP and FFKM
MOC : SS 316 - CHANGE OF MOC ON REQUEST

OPERATING CAPABILITIES

Shaft Dia. : 25mm to 100mm
Pressure : Up to 18 bar
Temperature: -30°C to 260°C (Depending upon Elastomer)
Speed : 3000 r.p.m.



Type - ZR800/S

Single Cartridge

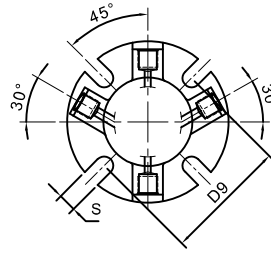
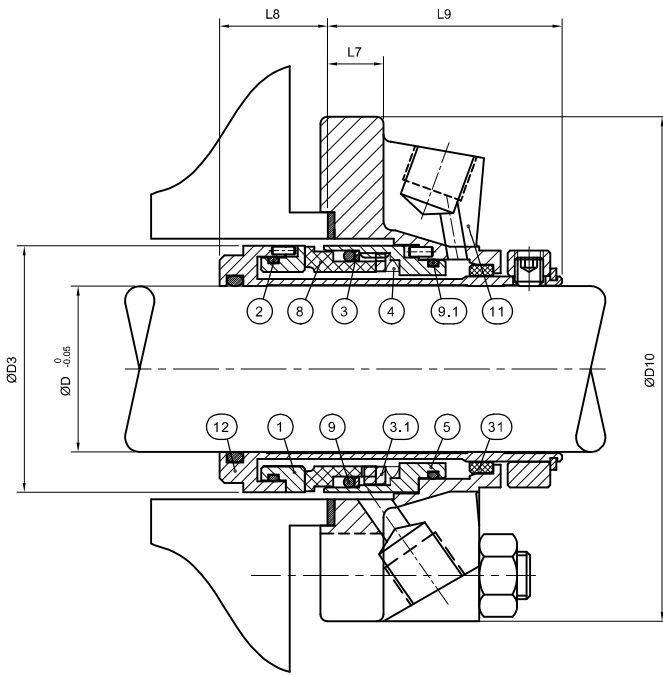

- | Part No. | Description |
|----------|---------------|
| 1 | Seal Ring |
| 2 | O-Ring |
| 3 | Thrust Ring |
| 3.1 | Thrust Ring |
| 4 | Spring |
| 5 | Spring Holder |
| 8 | Seat |
| 9 | O-Ring |
| 9.1 | O-Ring |
| 11 | Gland Plate |
| 12 | Sleeve |
| 31 | Throttle Bush |

SHAFT SIZE							
D	D9	D10	L7	L8	L9	L12	S
1.000	39.70	102.00	13.50	15.75	49.60	65.40	13.30
1.125	42.90	104.75	13.50	14.95	52.35	67.33	13.30
1.250	46.00	107.95	13.50	16.90	52.35	69.30	13.30
1.375	49.25	111.10	13.50	16.90	52.35	69.30	13.30
1.500	55.55	123.80	15.00	15.70	53.95	69.70	13.30
1.625	58.70	127.00	15.00	15.70	53.95	69.70	14.30
1.750	61.10	133.35	15.00	15.70	53.95	69.70	14.30
1.875	64.75	133.35	15.00	15.70	53.95	69.70	14.30
2.000	67.90	139.70	26.20	16.50	58.75	75.25	14.30
2.125	71.00	148.80	15.00	16.50	58.75	75.25	17.45
2.250	74.25	165.10	15.00	16.50	58.75	75.25	17.45
2.375	77.40	165.10	15.85	15.15	62.60	77.80	17.45
2.500	83.85	171.45	15.85	10.60	65.10	75.70	17.45
2.625	90.20	171.45	15.85	14.90	63.50	78.40	17.45
2.750	90.20	171.45	15.85	14.90	63.50	78.40	17.45
2.875	91.80	177.80	15.85	14.90	63.50	78.40	17.45
3.000	98.15	196.85	15.85	13.35	65.00	78.40	20.60
3.125	102.15	200.00	N/A	15.00	65.00	80.15	20.60
3.250	102.15	188.90	N/A	14.80	65.00	78.55	20.60
3.375	107.85	206.40	N/A	15.00	65.00	80.15	20.60
3.500	111.00	209.55	N/A	15.00	65.00	80.15	20.60
3.625	114.30	212.70	N/A	15.00	65.00	80.15	17.45
3.750	117.45	222.25	N/A	15.00	65.00	80.15	17.45
3.875	120.65	222.25	N/A	15.00	65.00	80.15	20.60
4.000	123.80	228.60	N/A	15.00	65.00	80.15	20.60

Due to continuous improvement specifications and dimensions may change without prior notice.